

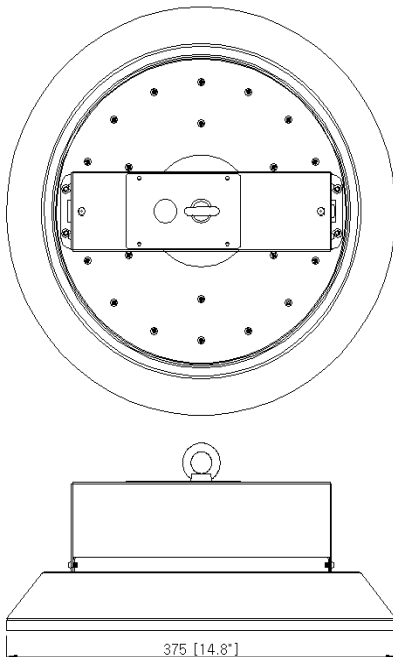

PRODUCT DESCRIPTION

- System Input Power: 93W
- Efficacy: 139 ~ 149 lm/W (@ 110°)
- Input Frequency: 50/60Hz

DIMENSIONS(mm)



PRODUCT SPECIFICATION

PERFORMANCE	FLC6A-09650L1US	FLC6A-09650C1US
Light Output (lm)	13,060	13,780
Input Power (W)	93	
Efficacy (lm/W)	139	149
CCT (K)	5000	
CRI (Ra)	> 80	
Power Factor	> 0.9	
Input Voltage	120~277	

※ Tolerance Range : ± 10%

PHYSICAL INFO	L×W×H
Dimension (mm / inch)	375x375x170/ 14.77x14.77x6.7
Weight (kg / lb)	2.7 / 5.73

CERTIFICATIONS & QUALIFICATIONS

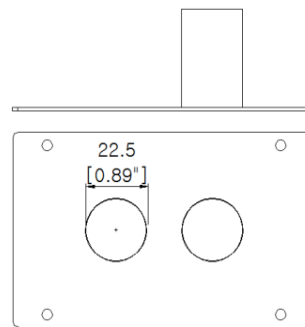

Pipe installation
Bracket

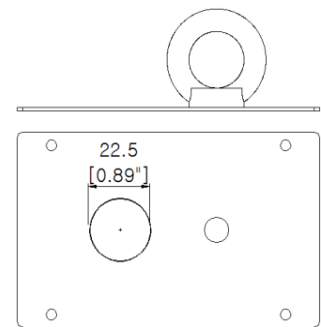

Pendant installation
Bracket

LIGHT DISTRIBUTION & DISTANCE LUMINARY

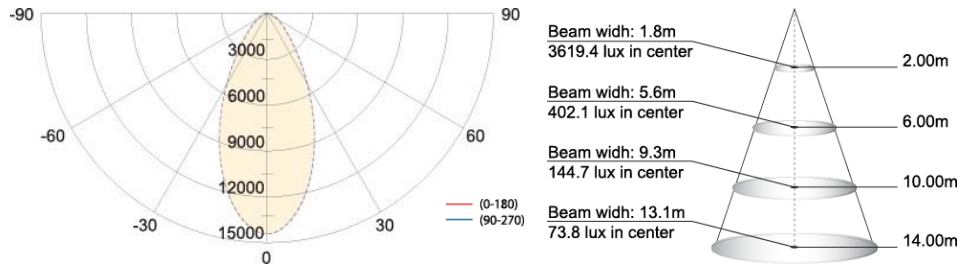

ZONAL LUMEN SUMMARY

Zone	Lumens	% Lamp	Luminaire
0~30	8,125	65	65
30~60	4,125	33	98
60~90	250	2	100
0~90	12,500	100	100

COEFFICIENTS OF UTILIZATION

RC	90				70				50			0
	60	50	30	10	60	50	30	10	50	30	10	0
RW	60	50	30	10	60	50	30	10	50	30	10	0
RCR (0)	1.10	1.10	1.10	1.10	1.08	1.08	1.08	1.08	1.06	1.06	1.06	1.00
1	1.04	1.03	1.01	0.99	1.02	1.01	0.99	0.97	0.99	0.97	0.96	0.92
2	0.98	0.95	0.92	0.88	0.95	0.93	0.90	0.87	0.92	0.89	0.86	0.83
3	0.92	0.89	0.84	0.80	0.89	0.87	0.82	0.79	0.85	0.81	0.78	0.75
4	0.86	0.82	0.77	0.72	0.84	0.81	0.76	0.72	0.79	0.75	0.71	0.69
5	0.81	0.77	0.71	0.66	0.79	0.75	0.70	0.66	0.74	0.69	0.66	0.63
6	0.76	0.72	0.66	0.61	0.74	0.70	0.65	0.61	0.69	0.64	0.61	0.59
7	0.71	0.67	0.61	0.57	0.70	0.66	0.60	0.56	0.65	0.60	0.56	0.54
8	0.67	0.63	0.57	0.53	0.66	0.62	0.57	0.53	0.61	0.56	0.52	0.51
9	0.64	0.59	0.53	0.49	0.62	0.59	0.53	0.49	0.58	0.53	0.49	0.47
10	0.60	0.56	0.50	0.46	0.59	0.55	0.50	0.46	0.55	0.50	0.46	0.44

CR = Room Cavity Ratio
 RC = Effective Ceiling Cavity Reflectance
 RW = Wall Reflectance

ORDERING INFORMATION

FL	C	6	A	-	096	50	L	A	US
Type	Size	No.	-	Wattage	CCT	Optic	Internal Code	Country	
FL	C	375	A	-	96W	5,000K	Lens	Internal Code	United States

LIGHT DISTRIBUTION & DISTANCE LUMINARY

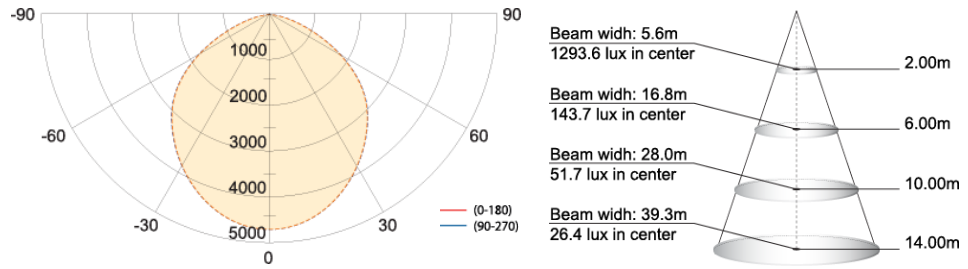

ZONAL LUMEN SUMMARY

Zone	Lumens	% Lamp	Luminaire
0~30	4,290	33	33
30~60	7,280	56	88
60~90	1,560	12	100
0~90	13,000	100	100

COEFFICIENTS OF UTILIZATION

RC	80				70				50			0
	60	50	30	10	60	50	30	10	50	30	10	0
RW	1.08	1.08	1.08	1.08	1.07	1.07	1.07	1.07	1.05	1.05	1.05	1.00
RCR (0)	1.00	0.98	0.95	0.93	0.98	0.97	0.94	0.92	0.95	0.93	0.90	0.86
1	0.91	0.88	0.83	0.78	0.89	0.87	0.82	0.78	0.85	0.80	0.77	0.74
2	0.82	0.78	0.72	0.67	0.81	0.77	0.71	0.66	0.75	0.70	0.66	0.63
3	0.75	0.70	0.63	0.57	0.73	0.69	0.63	0.57	0.68	0.62	0.57	0.54
4	0.68	0.63	0.56	0.50	0.67	0.62	0.55	0.50	0.61	0.54	0.49	0.47
5	0.62	0.57	0.50	0.44	0.61	0.57	0.49	0.44	0.55	0.49	0.44	0.41
6	0.57	0.52	0.44	0.39	0.56	0.52	0.44	0.39	0.50	0.44	0.39	0.36
7	0.53	0.48	0.40	0.35	0.52	0.47	0.40	0.35	0.46	0.39	0.35	0.32
8	0.49	0.44	0.36	0.31	0.48	0.43	0.36	0.31	0.42	0.36	0.31	0.29
9	0.46	0.41	0.33	0.28	0.45	0.40	0.33	0.28	0.39	0.33	0.28	0.26
10												

CR = Room Cavity Ratio
RC = Effective Ceiling Cavity Reflectance
RW = Wall Reflectance

ORDERING INFORMATION

FL	C	6	A	-	096	50	C	A	US
Type	Size	No.	-	Wattage	CCT	Optic	Internal Code	Country	
FL	C	375	A	-	95W	5,000K	Cover	Internal Code	United States