



PRODUCT DESCRIPTION

- Injected Molded and Seamless for Maximum Durability
- System Input Power: 45W
- Efficacy: 139 lm/W
- Input Frequency: 50/60Hz
- On/Off
- IP65 – Protected: No ingress of Dust / Water projected from water jets in any direction.
- Dry & Wash Down Location

Accessory - Stainless Steel Hanging Bracket



PRODUCT SPECIFICATION

PERFORMANCE	TT4FT-045ZT50SUS
Light Output (lm)	6,200
Power (W)	45
LPW (lm/W)	139
CCT (K)	5,000
CRI (Ra)	> 80
Power Factor	> 0.9
Input Voltage	120 – 277

※ Tolerance ± 10%

PHYSICAL INFO	L×W×H
Dimension (mm / inch)	1200 x 135 x 118 / 47.2 x 5.3 x 4.6
Weight (kg / lb)	2.5 / 5.5

CERTIFICATIONS & QUALIFICATIONS



DIMENSIONS

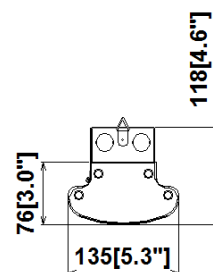
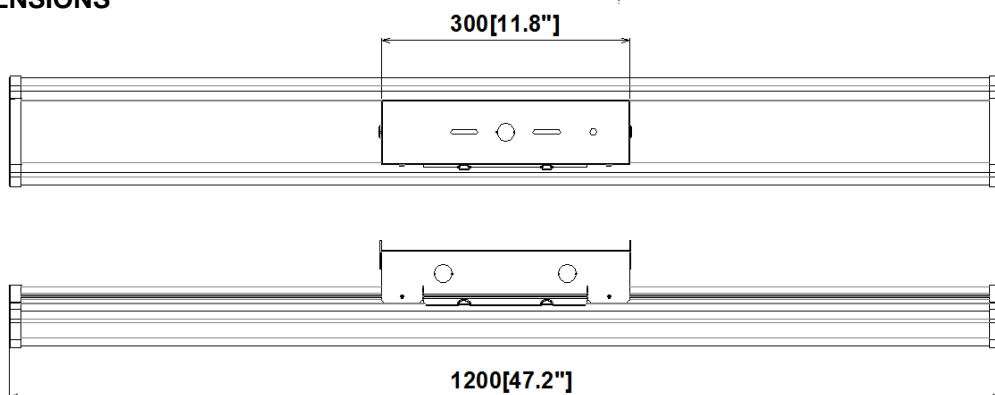

[LIGHTING AREA]

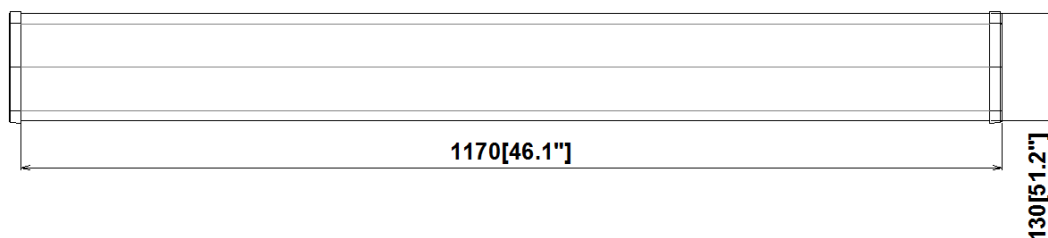

LIGHT DISTRIBUTION & DISTANCE LUMINARY – TT4F-045ZT50SUS

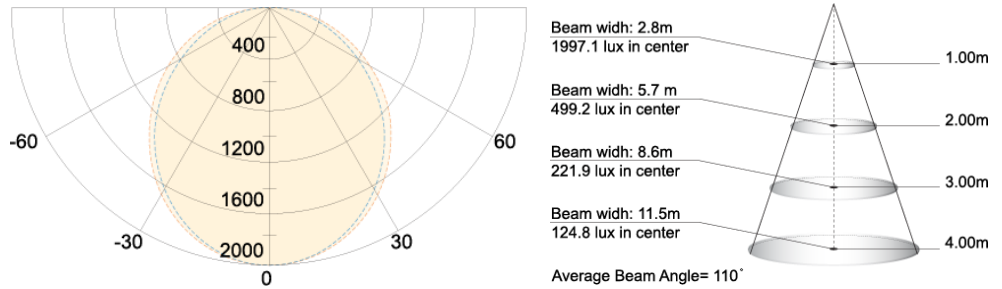

ZONAL LUMEN SUMMARY

Zone	Lumens	% Lamp	Luminaire
0~30	1,767	29	29
30~60	2,825	47	47
60~90	1,185	20	20
0~90	5,777	96	96
90~180	223	4	4
0~180	6,000	100	100

COEFFICIENTS OF UTILIZATION

RC	90				70				50			0
	RW 60	50	30	10	60	50	30	10	50	30	10	0
RCR (0)	1.12	1.12	1.12	1.12	1.08	1.08	1.08	1.08	1.05	1.05	1.05	0.97
1	1.00	0.98	0.94	0.90	0.96	0.94	0.91	0.88	0.91	0.88	0.85	0.79
2	0.90	0.86	0.80	0.74	0.86	0.83	0.77	0.72	0.80	0.75	0.71	0.65
3	0.81	0.76	0.68	0.62	0.77	0.73	0.66	0.60	0.70	0.64	0.59	0.55
4	0.73	0.68	0.59	0.52	0.70	0.65	0.58	0.51	0.63	0.56	0.51	0.46
5	0.67	0.61	0.52	0.45	0.63	0.58	0.51	0.44	0.56	0.49	0.44	0.40
6	0.61	0.55	0.46	0.39	0.58	0.53	0.45	0.39	0.51	0.44	0.38	0.35
7	0.56	0.50	0.41	0.35	0.53	0.48	0.40	0.34	0.46	0.39	0.34	0.31
8	0.52	0.46	0.37	0.31	0.49	0.44	0.36	0.31	0.42	0.35	0.30	0.27
9	0.48	0.42	0.34	0.28	0.46	0.40	0.33	0.27	0.39	0.32	0.27	0.25
10	0.44	0.39	0.31	0.25	0.42	0.37	0.30	0.25	0.36	0.29	0.25	0.22

CR = Room Cavity Ratio
RC = Effective Ceiling Cavity Reflectance
RW = Wall Reflectance

ORDERING INFORMATION

TT	4FT	-	045	ZT	50	HB					
Model	Size(ft)		-	Wattage		Control type	CCT		Hanging Bracket		
TURTLE	4FT	4feet	-	045	45W	ZT	Dimming (1-10)	50	5,000K	HB	Hanging Bracket